

localização de coordenadas de implantação

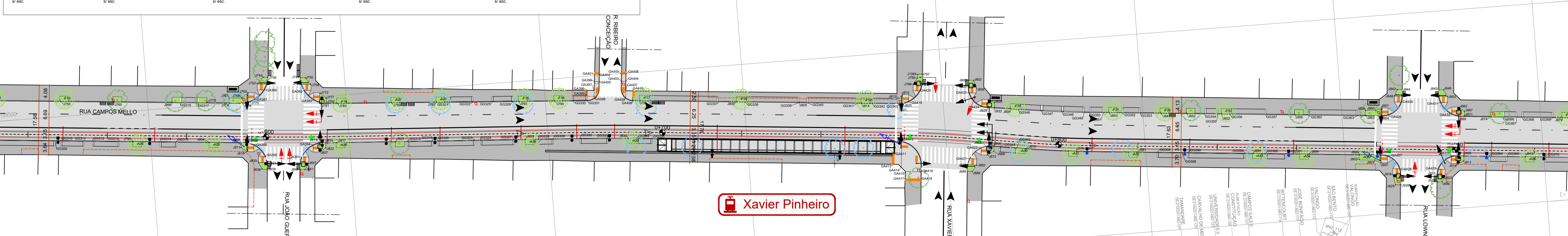
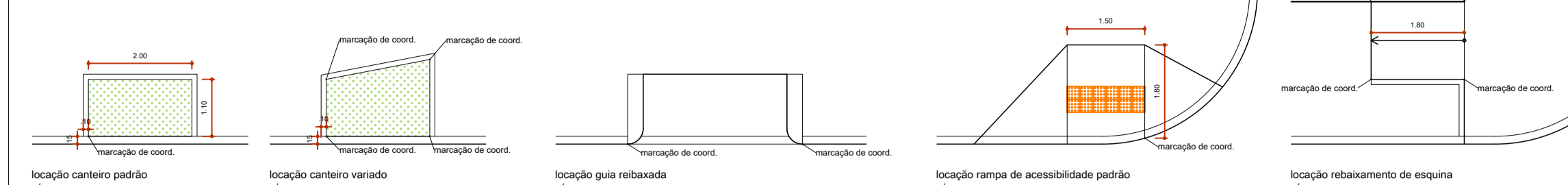

G - PONTOS PARA LOCAÇÃO DE GUIAS E RAMPAIS

Table with columns for coordinate points (GA001 to GA400) and their respective X and Y values.

J - PONTOS PARA LOCAÇÃO DE CANTEIROS

Table with columns for coordinate points (GA401 to GA440) and their respective X and Y values.

COORDENADAS - ARVORES

Table with columns for tree coordinates (A01 to A40) and their respective X and Y values.

COORDENADAS - ARVORES

Table with columns for tree coordinates (A41 to A80) and their respective X and Y values.

COORDENADAS - ARVORES

Table with columns for tree coordinates (A81 to A120) and their respective X and Y values.

COORDENADAS - ARVORES

Table with columns for tree coordinates (A121 to A160) and their respective X and Y values.

COORDENADAS - ARVORES

Table with columns for tree coordinates (A161 to A200) and their respective X and Y values.

COORDENADAS - ARVORES

Table with columns for tree coordinates (A201 to A240) and their respective X and Y values.

COORDENADAS - ARVORES

Table with columns for tree coordinates (A241 to A280) and their respective X and Y values.

COORDENADAS - ARVORES

Table with columns for tree coordinates (A281 to A320) and their respective X and Y values.

COORDENADAS - ARVORES

Table with columns for tree coordinates (A321 to A360) and their respective X and Y values.

COORDENADAS - ARVORES

Table with columns for tree coordinates (A361 to A400) and their respective X and Y values.

LEGENDA

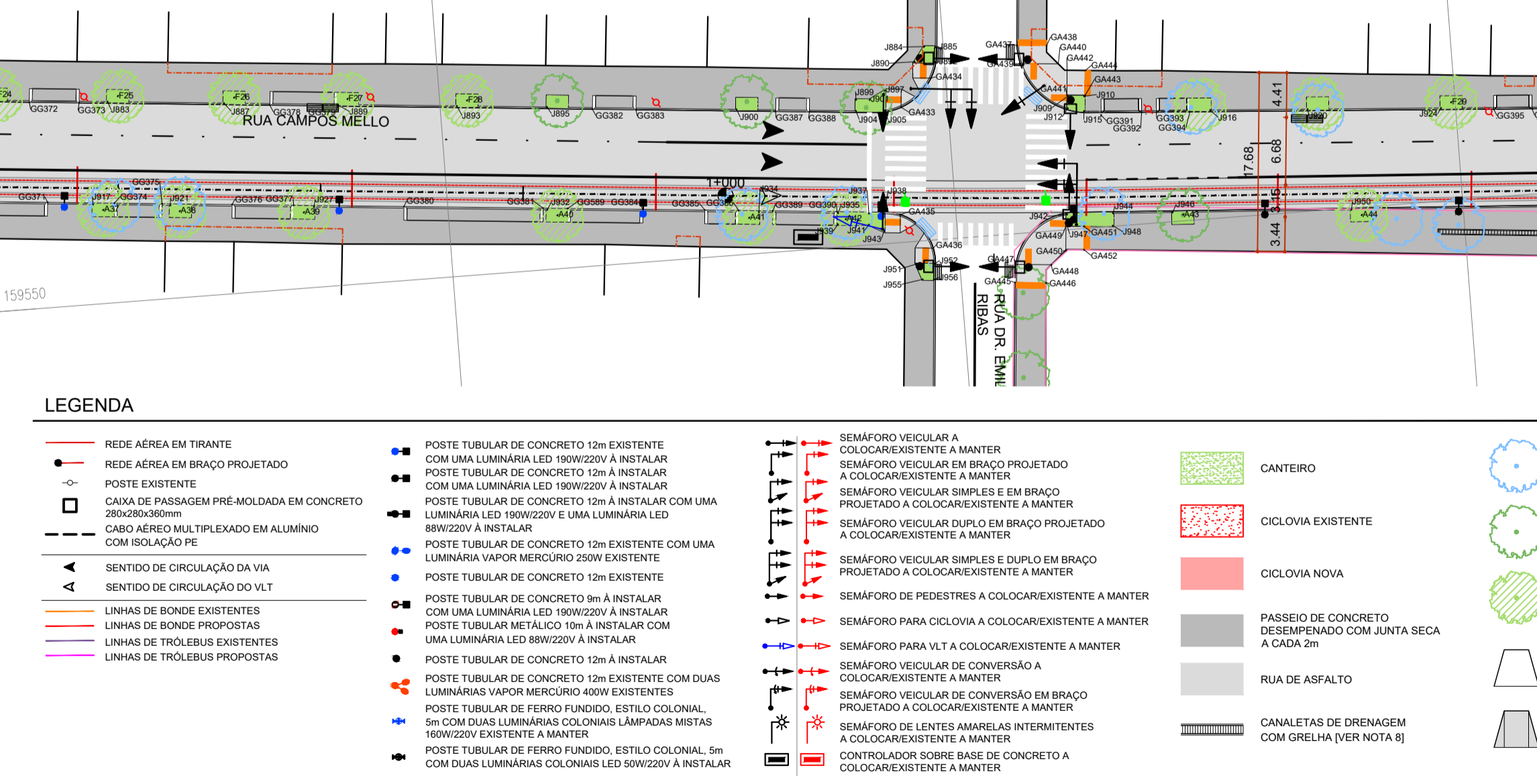

Table with columns for 'Revisões' (revisions) including date, description, and responsible person.

LEGENDA

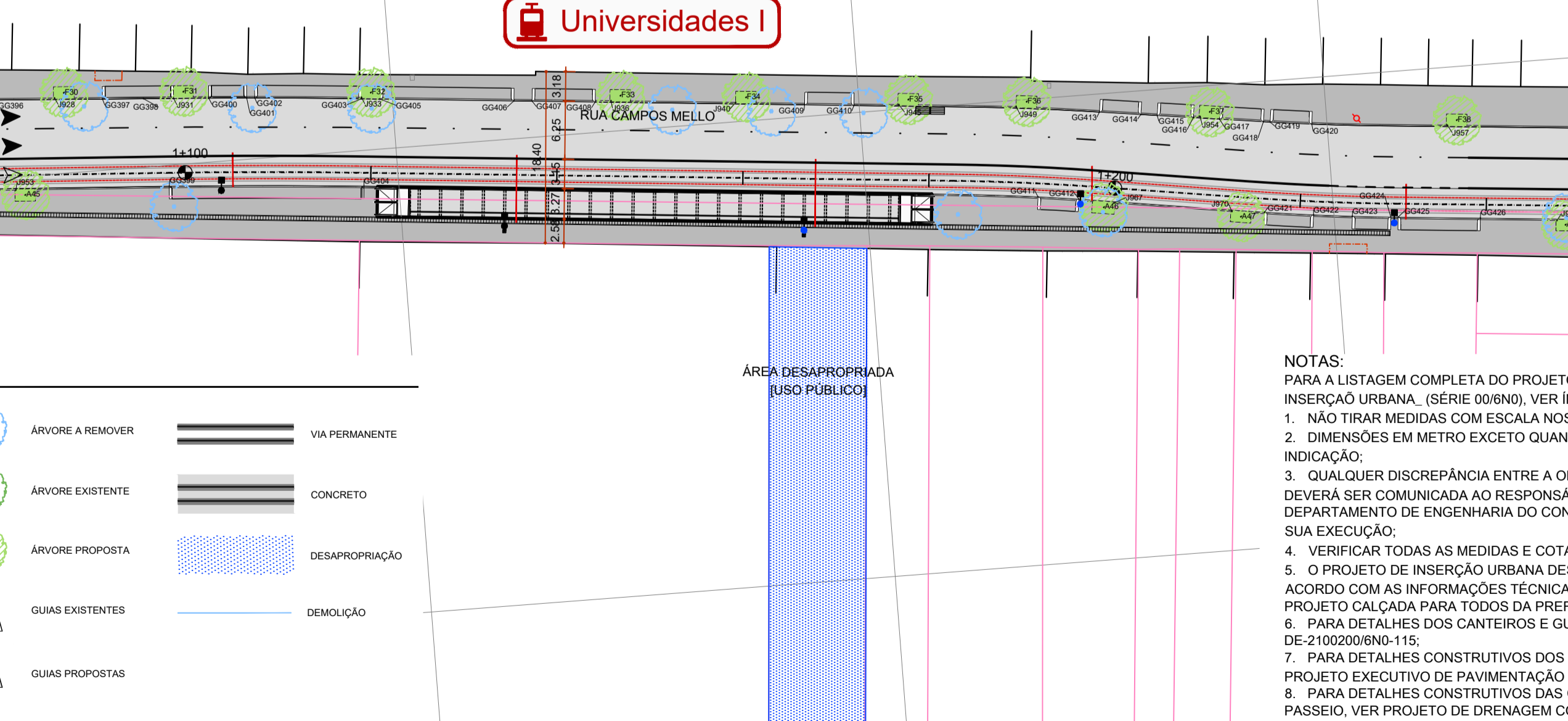

Table with columns for 'Revisões' (revisions) including date, description, and responsible person.

LEGENDA

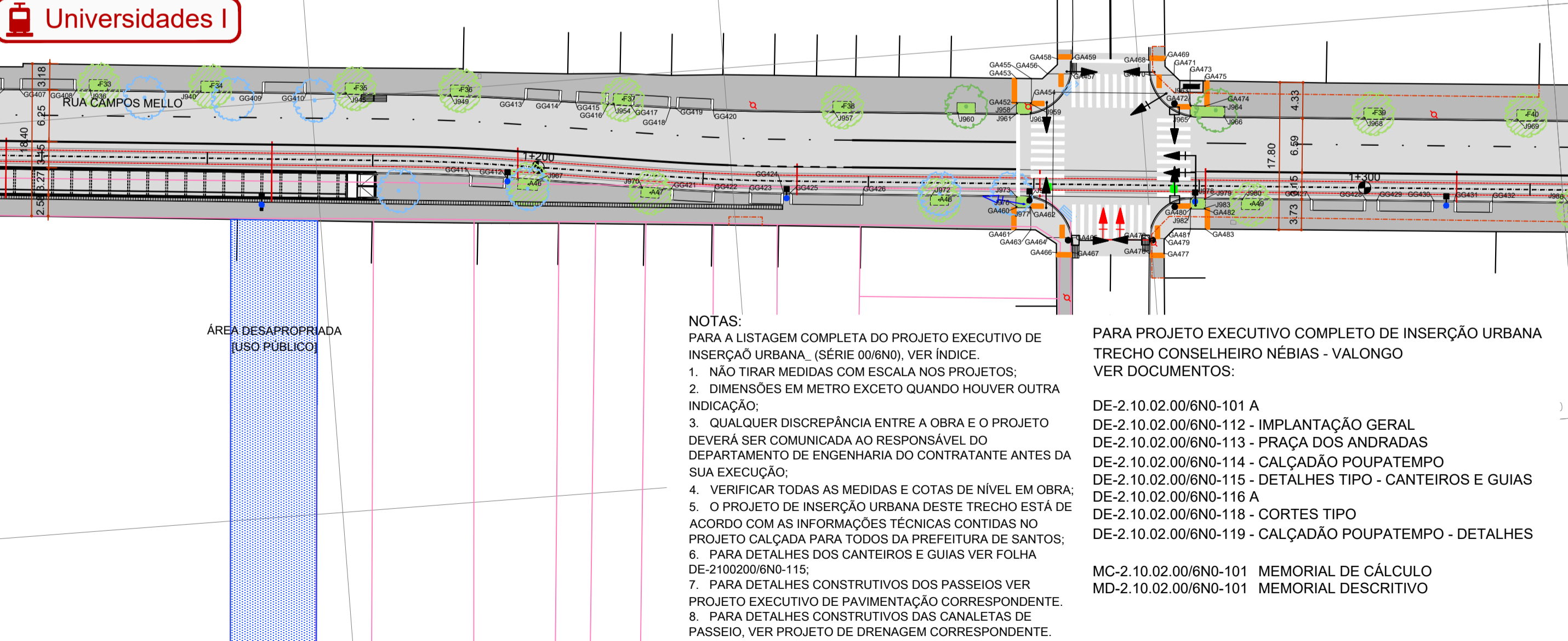

Table with columns for 'Revisões' (revisions) including date, description, and responsible person.